

Done

Completion of Registration.pdf



Land Registry Official copy of title plan

Title number **WK259789**
Ordnance Survey map reference **SP3474SE**
Scale **1:2500**
Administrative area **Warwickshire: Warwick**

© Crown Copyright. Produced by Land Registry. Reproduction in whole or in part is prohibited without the prior written permission of Ordnance Survey. Licence Number 100026316.

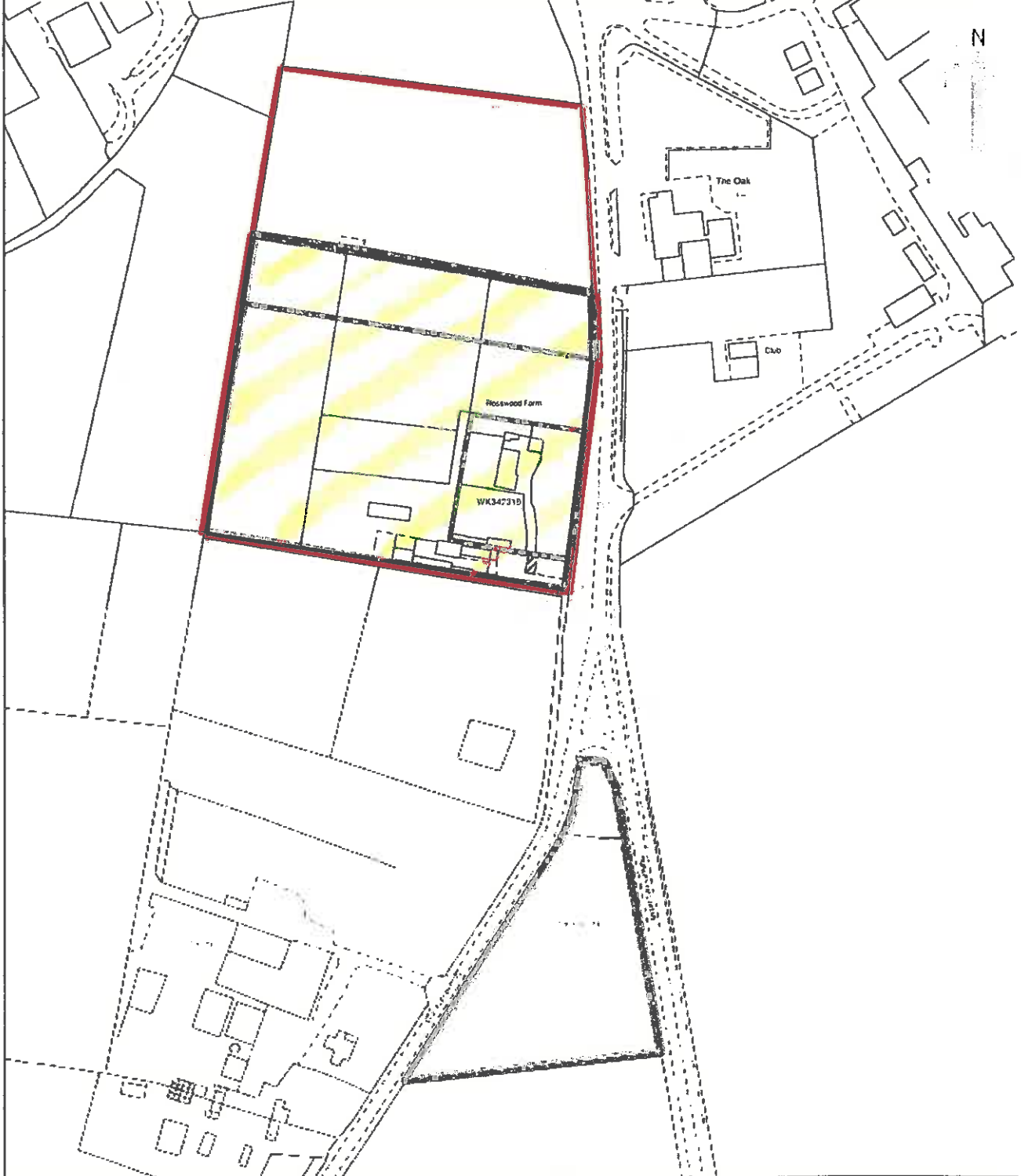

This official copy issued on 27 May 2014 shows the state of this title plan on 14 March 2014 at 17:39:04. It is admissible in evidence to the same extent as the original (s.67 Land Registration Act 2002). This title plan shows the general position, not the exact line, of the boundaries. It may be subject to distortions in scale.