











-  Site boundary
-  Existing woodland to be retained
-  Existing hedgerow to be retained/ replaced
-  Existing open spaces / destinations
-  Proposed tree / woodland planting belts
-  Proposed open spaces / destinations
-  Proposed sustainable drainage / attenuation areas
-  Proposed primary green access links
-  Proposed urban tree planting within development
-  Proposed grassland meadows
-  Potential future pedestrian links with wider area
-  Proposed linear open space

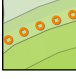

PREVIOUSLY APPROVED
RESIDENTIAL DEVELOPMENT
(REF W/13/0607)



KEY					
	Site boundary		Proposed landscape infrastructure planting		Proposed plots tree planting
	Existing vegetation to be retained		Proposed public open space tree planting		Potential location of children's play space
	Existing hedgerows to be retained		Proposed primary route tree planting		Potential location for allotments
			Proposed hedgerow planting		Proposed indicative attenuation area
			Indicative pedestrian routes		Existing contours
					Sports pitches

3.8
Land at Lower Heathcote Farm
Illustrative Landscape Masterplan

1:2500 @ A2
Bir.4361_53

FIGURE TITLE
SCALE
DWG. NO

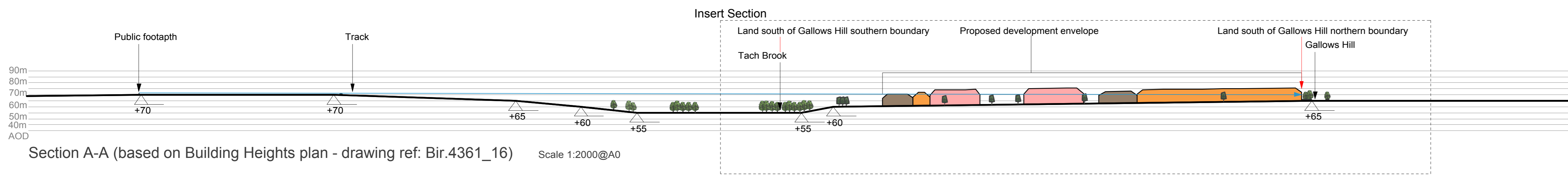

Section A-A (based on Building Heights plan - drawing ref: Bir.4361_16) Scale 1:2000@A0

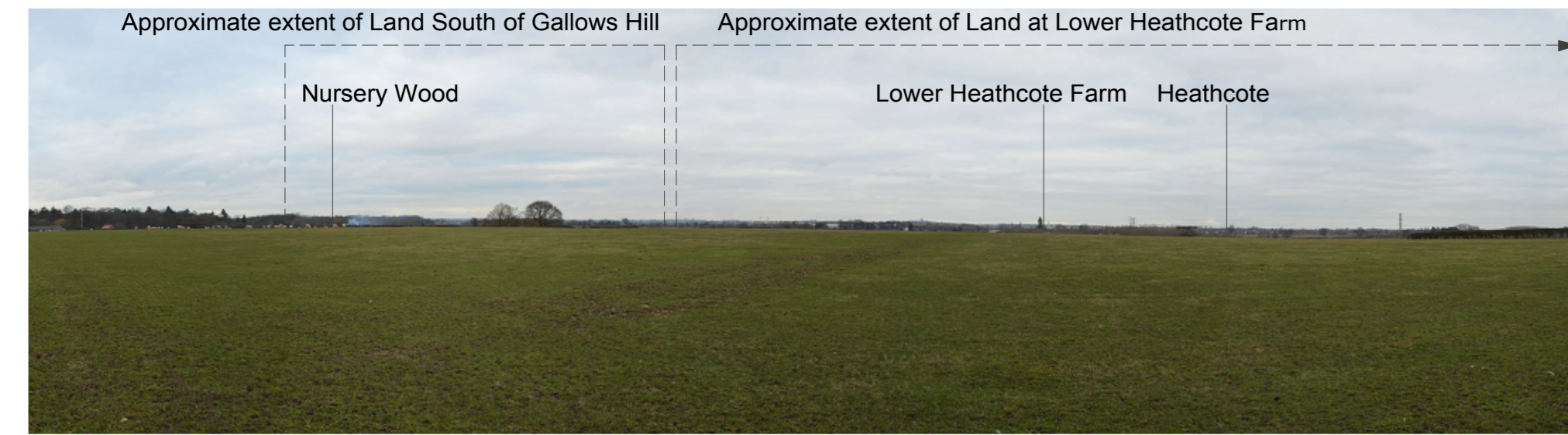

View 11: View from public right of way west of the A452, looking north-east.

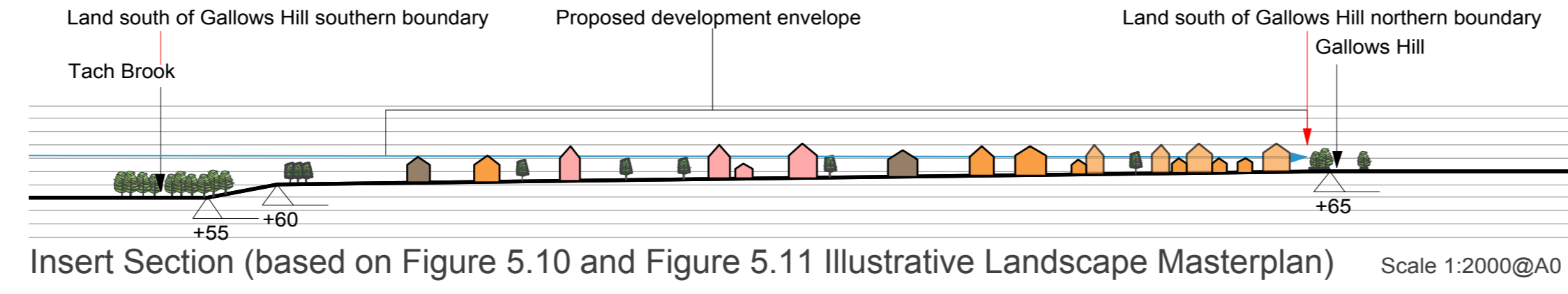

Insert Section (based on Figure 5.10 and Figure 5.11 Illustrative Landscape Masterplan) Scale 1:2000@A0

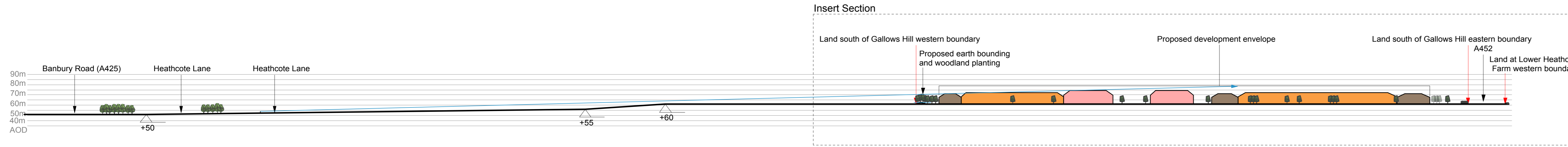

Section B-B (based on Building Heights plan - drawing ref: Bir.4361_16) Scale 1:2000@A0



View 24: View from Gallows Hill looking south-east.

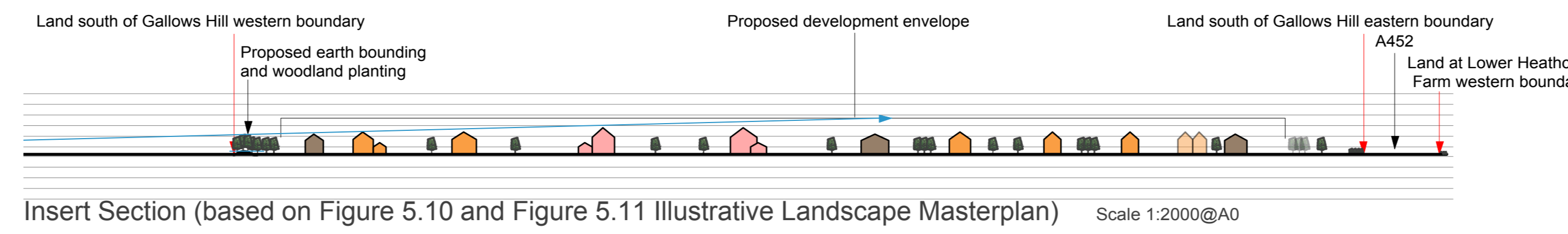

Insert Section (based on Figure 5.10 and Figure 5.11 Illustrative Landscape Masterplan) Scale 1:2000@A0

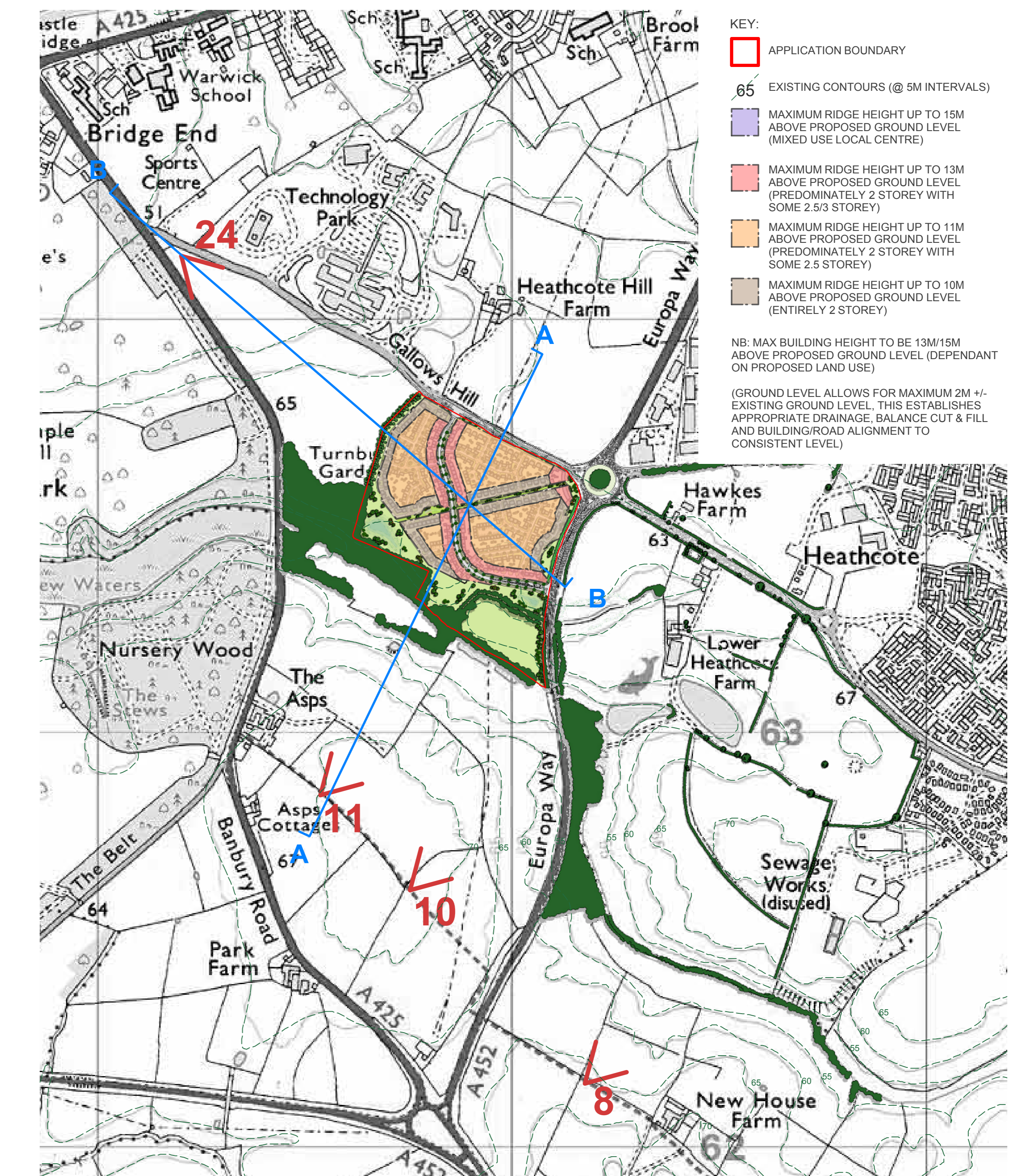

Section Location and Photo View Location Plan 1:7500@A0

- KEY:**
- Maximum ridge height up to 10m AGL
 - Maximum ridge height up to 11m AGL
 - Maximum ridge height up to 13m AGL
 - Proposed mitigation planting shown at 8m AGL
 - Sight lines

Notes:
 - Building heights based on Bulding Heights drawings (drawings reference no: Bir.4361_16)

© Copyright Pygmalion Planning Group Ltd. © Crown Copyright. All rights reserved. Ordnance Survey Copyright Licence number: 100042000. 1. Drawings prepared for planning application purposes and can be used for construction or other documents. Please refer to (any) other development consent documents. Pygmalion Urban Design is a part of Pygmalion Planning Group Ltd. Any queries to be referred to Pygmalion for clarification.

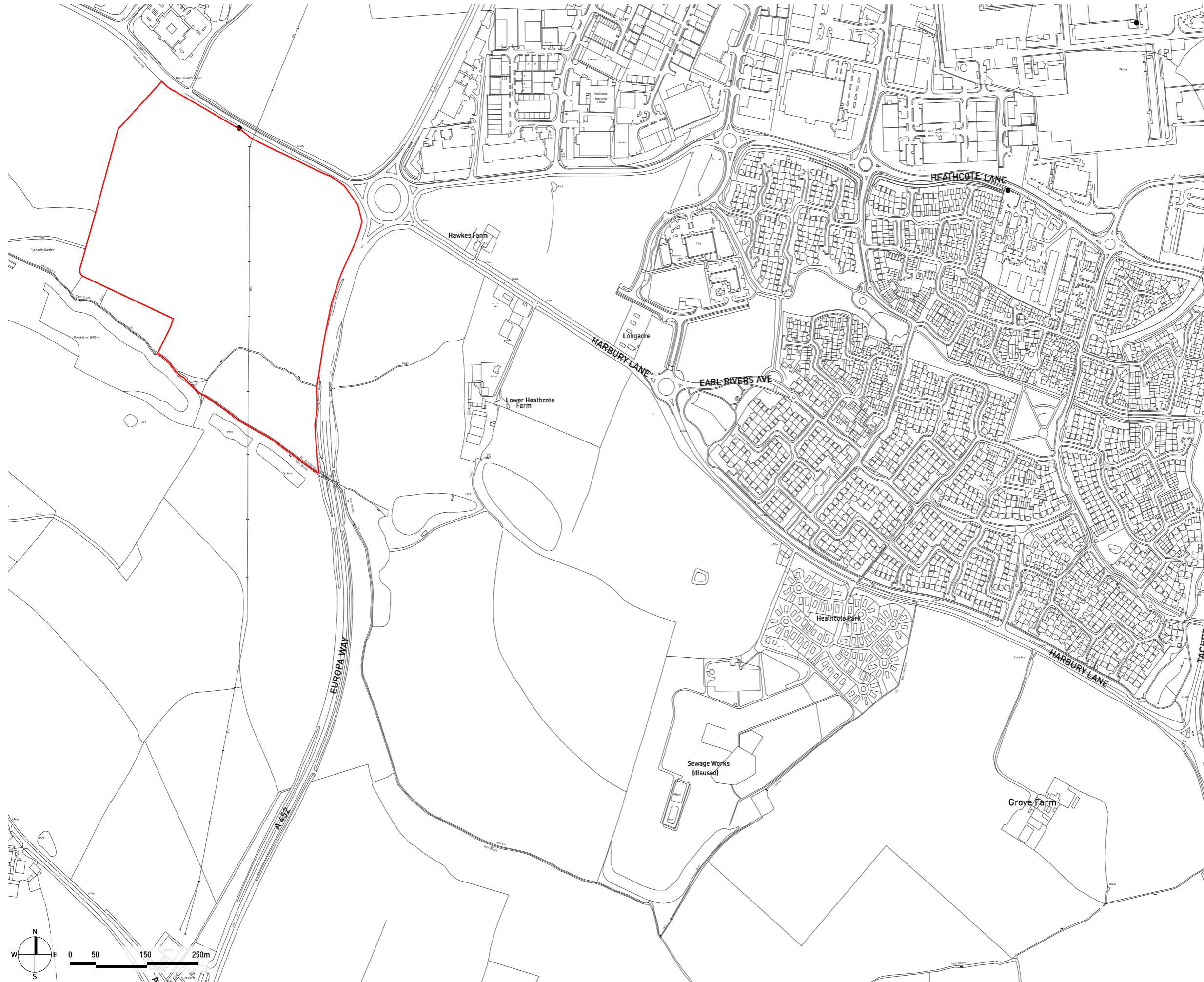

KEY:
SITE BOUNDARY [21.76HA]

1.2 FIGURE
Site Location Plan TITLE

1: 1500 @ A2 SCALE
Bir.4361_02-3 DWG.NO

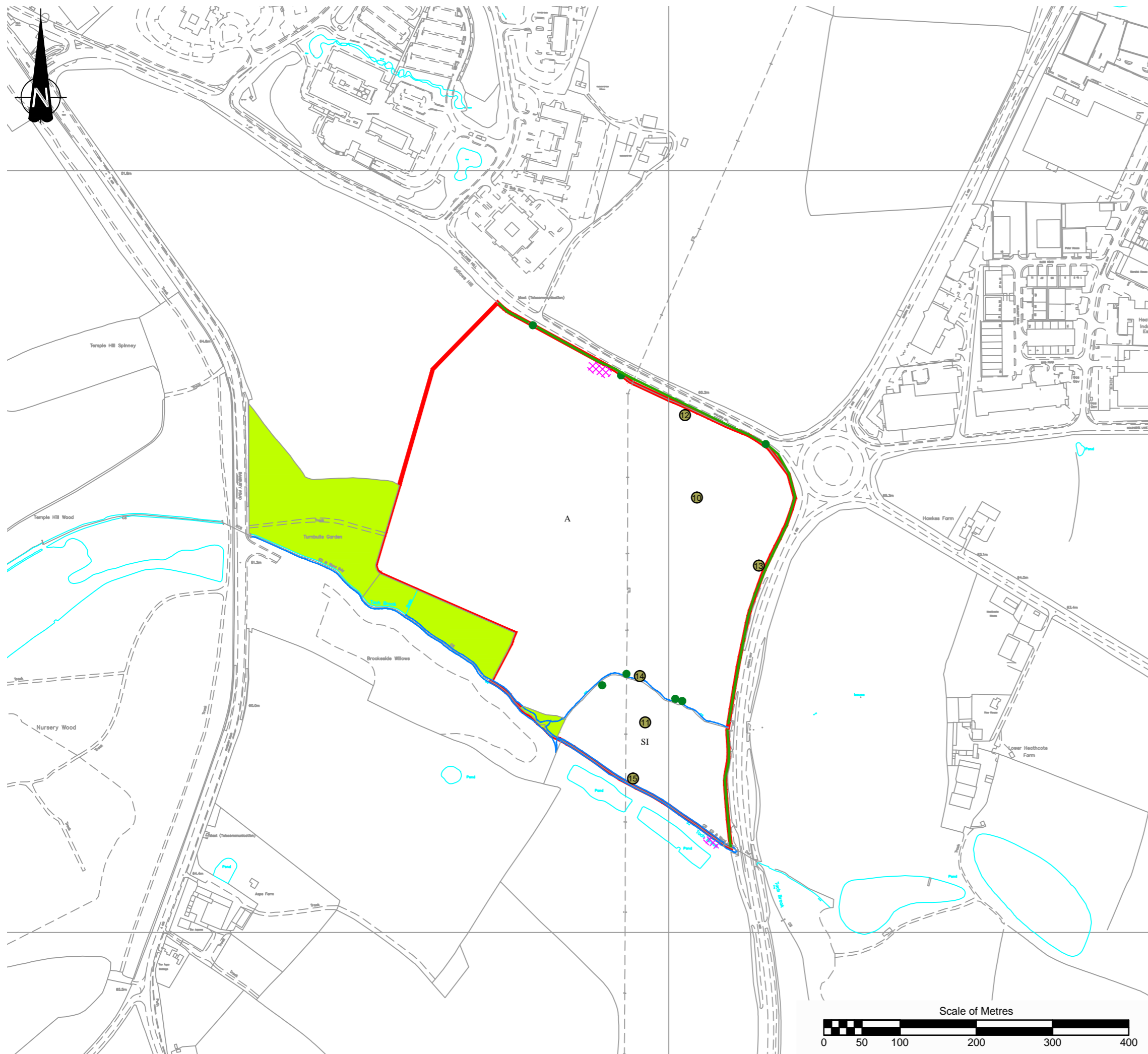

REFERENCE

- Proposed Site Boundary --- —
- Japanese Knotweed ---
- Scrub ---
- Broadleaved Woodland ---
- Stream/Ditch --- ---
- Mature Trees --- ●
- Hedgerow --- —
- Arable --- A
- Poor Semi-Improved Grassland --- SI
- Target Note --- 1

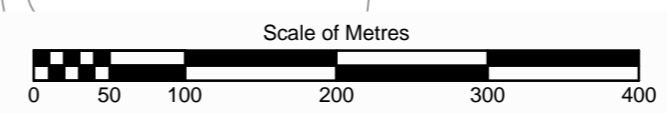

4.1 FIGURE
Phase 1 Habitat Plan TITLE

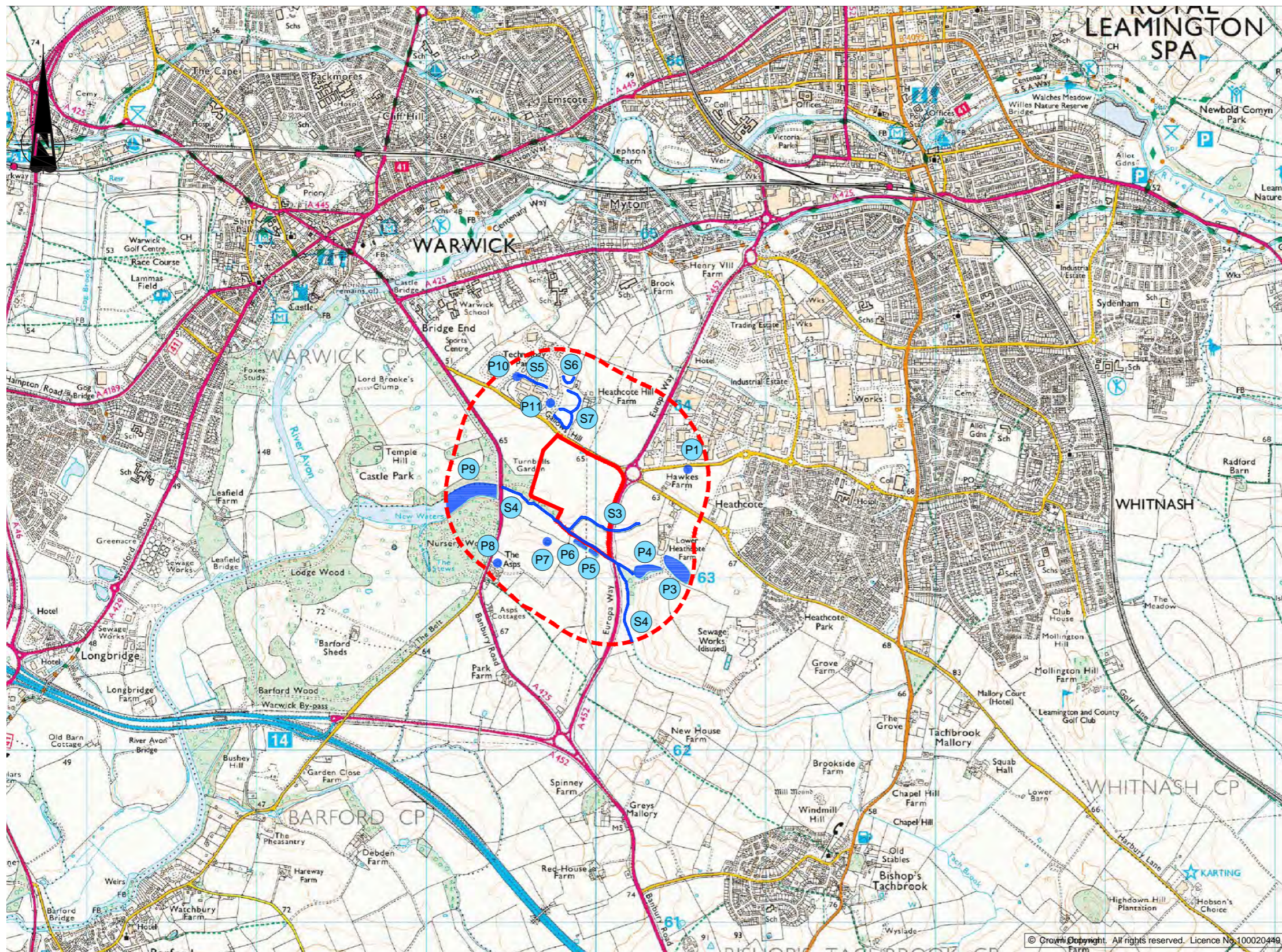

REFERENCE

- Site boundary _____ - - - - -
- 500m Radius to site boundary _____ - · - · -
- Pond reference numbers _____ P1
- Stream reference numbers _____ S4

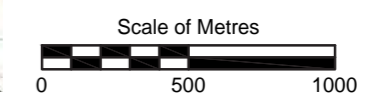

4.2 FIGURE
Pond Location Plan TITLE

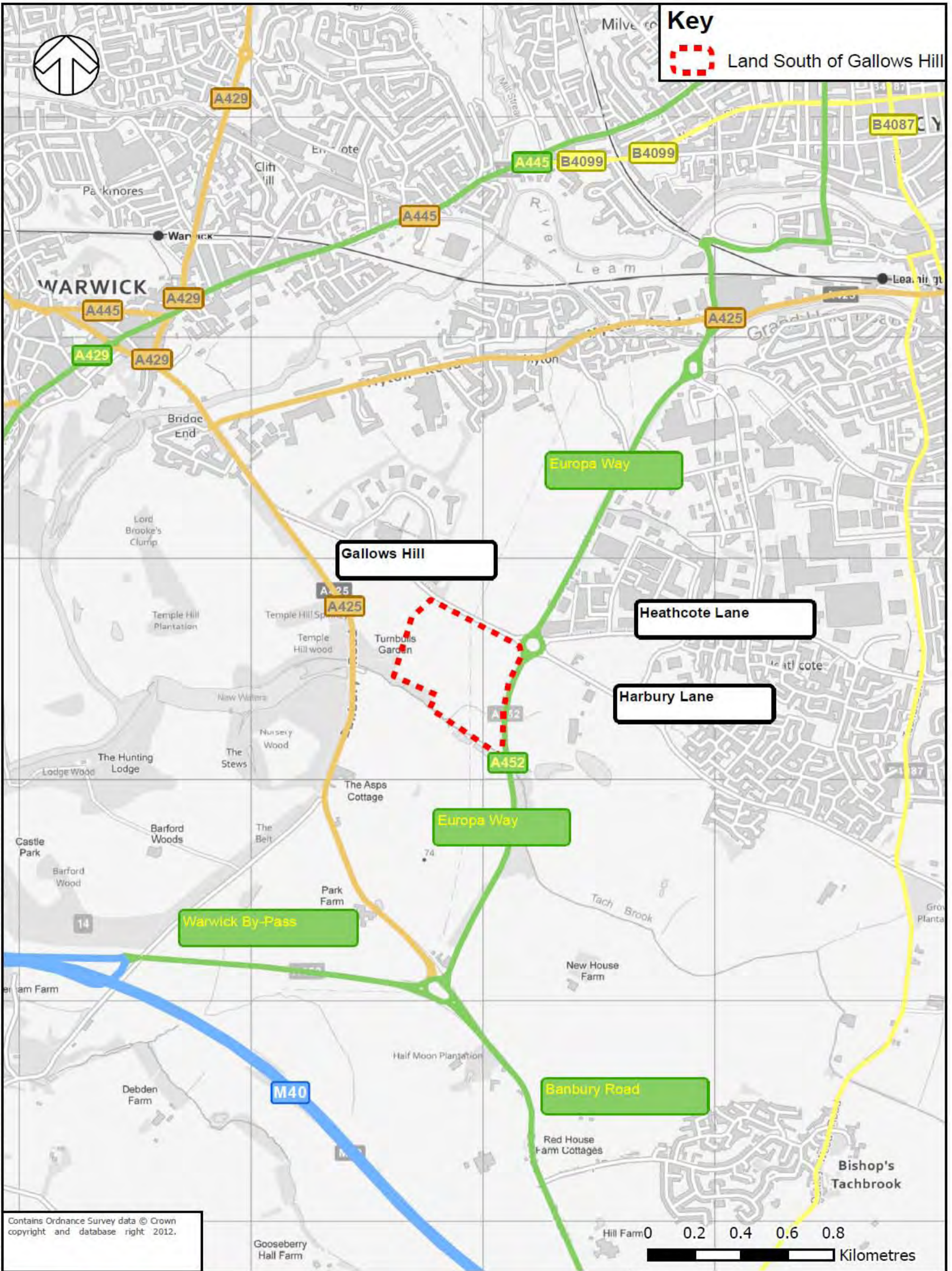

6.1 FIGURE
Local Highway Network TITLE
NTS @ A3 SCALE
BIR.4361_6.1 DWG.NO

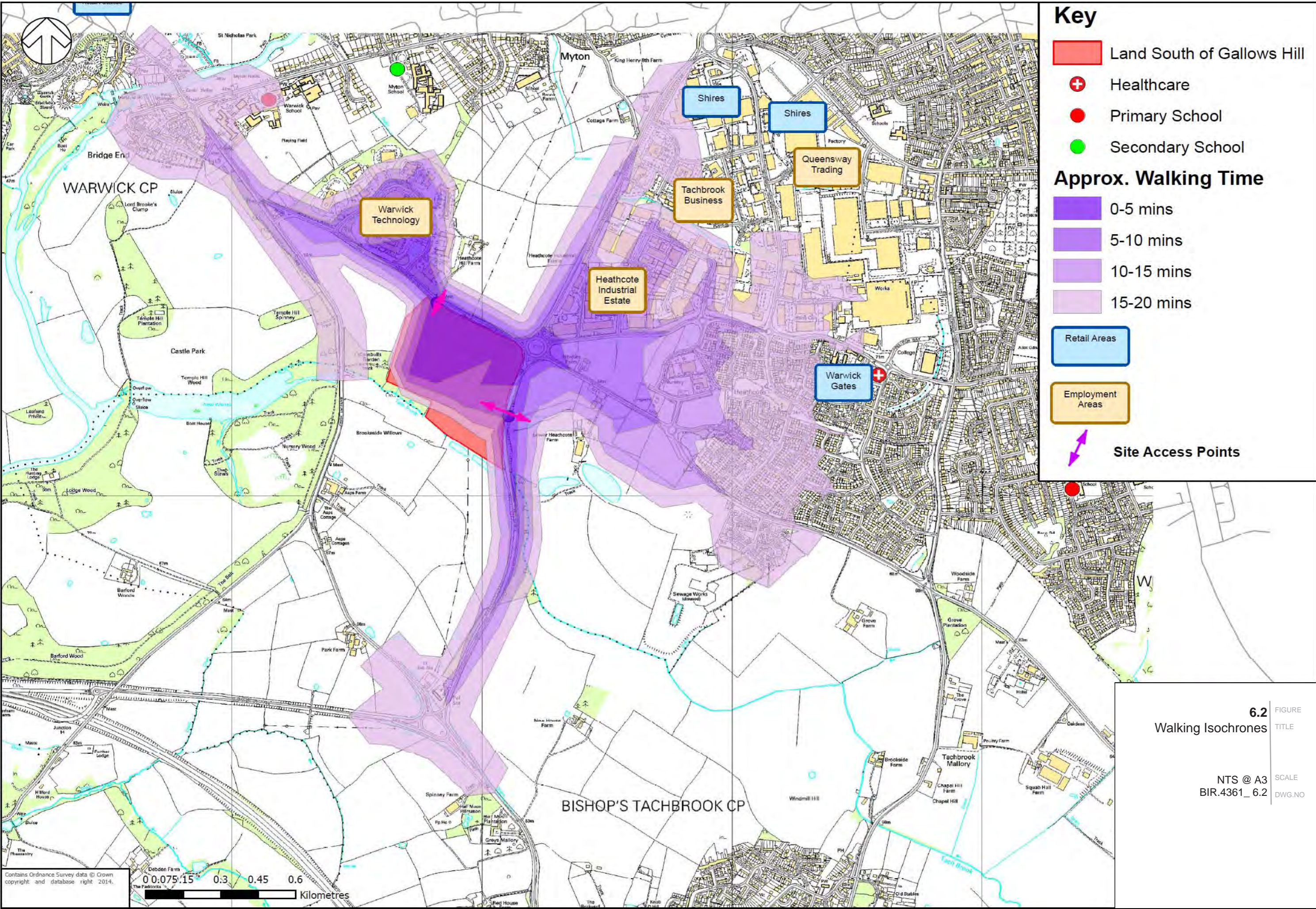

Key

- Land South of Gallows Hill
- + Healthcare
- Primary School
- Secondary School

Approx. Walking Time

- 0-5 mins
- 5-10 mins
- 10-15 mins
- 15-20 mins

Retail Areas

Employment Areas



Site Access Points

6.2 Walking Isochrones

FIGURE TITLE

NTS @ A3
BIR.4361_6.2

SCALE
DWG.NO

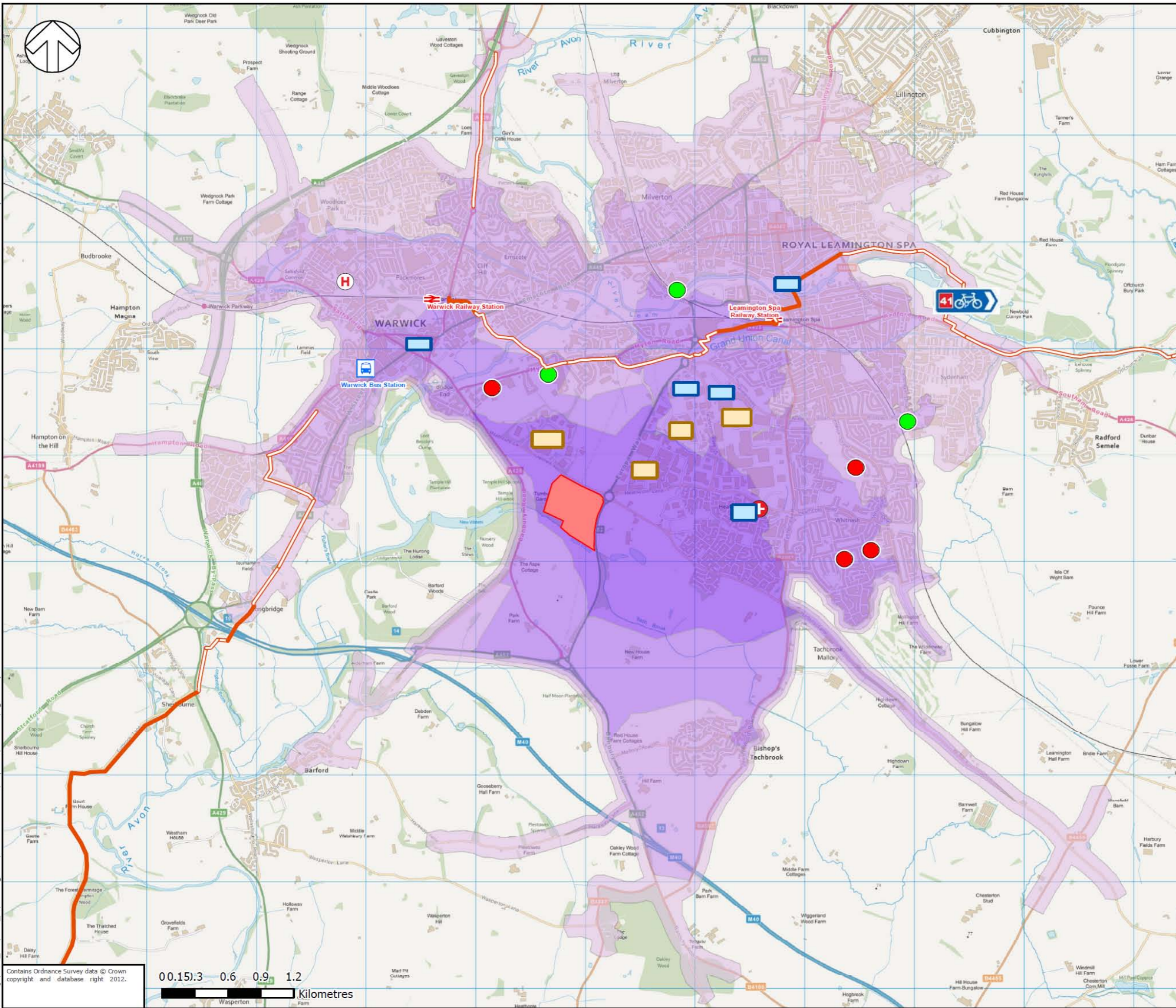

Key

- Land South of Gallows Hill
- Bus
- Secondary School
- Primary School
- Hospital
- Healthcare
- Rail

Sustrans National Route Type

- National Route (on road)
- National Route (off road)









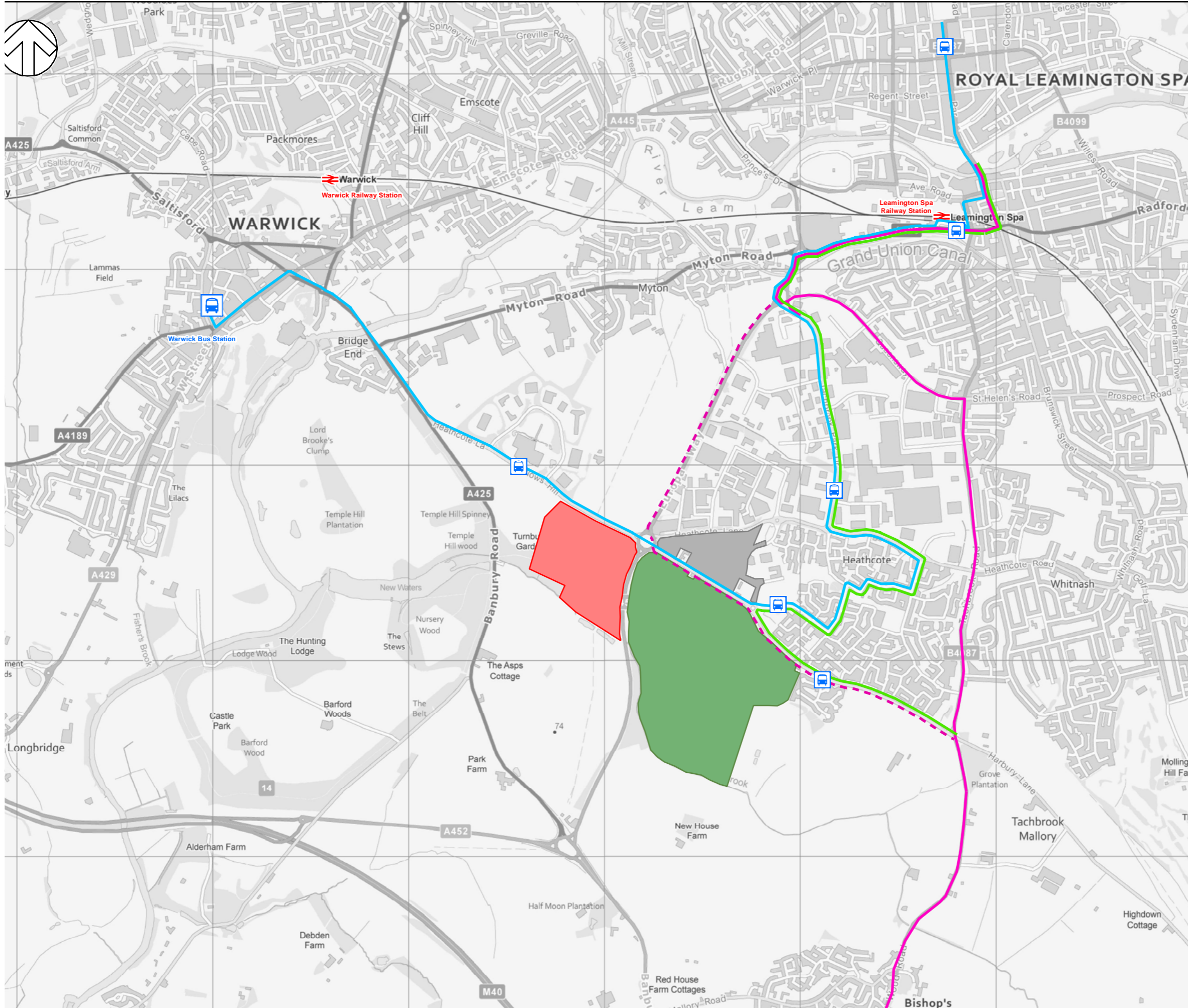

Cycling Isochrone (Speed 4.4 m/s)

- 0 - 5 minutes
- 5 - 10 minutes
- 10 - 15 minutes
- 15 - 20 minutes

- Employment Areas
- Retail Areas

6.3 FIGURE
Cycling Isochrones TITLE
NTS @ A3 SCALE
BIR.4361_ 6.3 DWG.NO

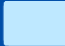

- Key**
-  Bus Stops
 -  Bus Stations
 -  No. 68 Bus Service
 -  No. 67a b services
 -  No. 77 Occasional Service
 -  No. 77 Service
 -  Rail
 -  North of Harbury Lane (Cor)
 -  Lower Heathcote Farm (Pr
 -  South of Gallows Hill (Prop
 -  Employment Areas
 -  Retail Areas

6.4
Existing Public
Transport

Y:\LOWER HEATHCOTE\DRAWINGS\SKETCHES\LPR CHAPTER FIG 6.5.DWG 19/06/2014 14:44:36 Price, Thomas



KEY:

- EXISTING 68 SERVICE
- 68 SERVICE DIVERSION (SECTION OF EXISTING ROUTE NO LONGER USED)
- NEW 68 SERVICE ROUTE

6.5 FIGURE
 Public Transport Strategy TITLE
 Bus Service Improvement

NTS @ A3 SCALE
 Bir.4361_6.5 DWG.NO

Reproduced from the Ordnance Survey map with the permission of the Controller of Her Majesty's Stationary Office. Licence no. 100048755. Crown copyright reserved.